



“Expansion Fin Zert” is designed to be installed into a wide variety of thermoplastics. The insert is a cold push-in insert that collapses during installation. As the screw is installed into the insert it expands allowing the fins to penetrate the plastic. This feature gives the insert a thread locking effect. *Performance values are on page 35.*

Plastic Materials

PA - Unfilled	PE
POM (Acetal)	HDPE
PP	PVC
ABS	

Insert

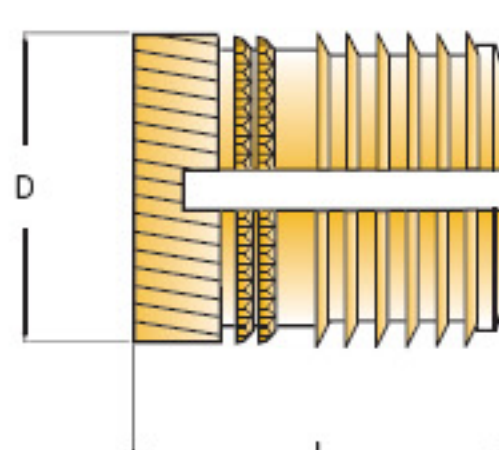

Installation

Hand Tools	Fully Automated
Simple Press	

Materials

Brass

Boss Design Reference

“Expansion Fin Zert” is designed to be installed into a straight hole with a maximum of a 1° inclusive taper. Holes should not be counter sunk or counter bored as this will decrease the fasteners performance. The recommended hole size applies at the point reached by the bottom of the insert. Hole size tolerance $-0.000 + 0.004$ inches. This design of insert allows the insert to be installed with basic Installation equipment including hand presses / hammers. It is important that the screw fully penetrates the insert to allow for full expansion of the insert. Available In Brass. (other materials may be available on request)

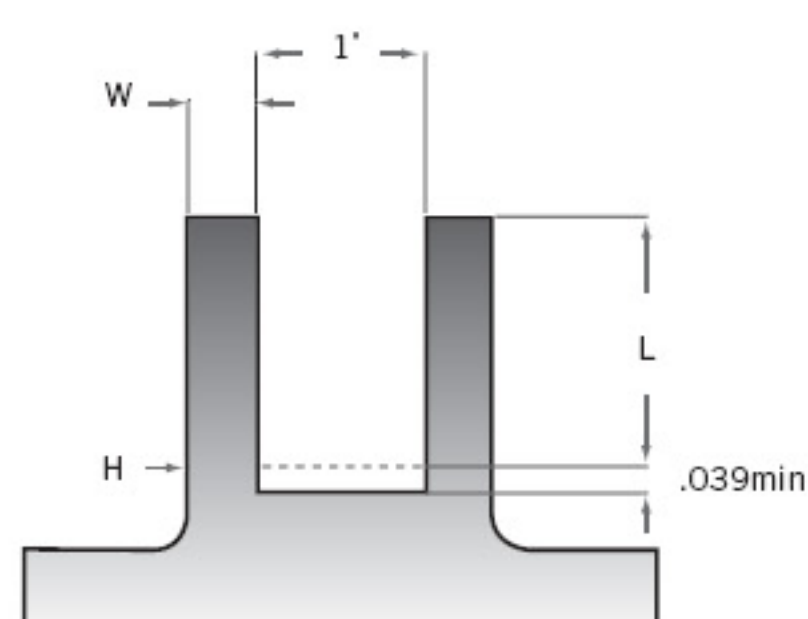

Expansion Fin Zert Size Chart

Inch	Thread	L Insert Length	D Insert Dia.	H Hole Size (+.004 -.000)	W Min. Wall Thickness	Part Number
	2 - 56	.157	.146	.126	.063	EFZ - 256 - 157
4 - 40	.228	.177	.157	.079	EFZ - 440 - 228	
6 - 32	.283	.209	.189	.094	EFZ - 632 - 283	
8 - 32	.323	.242	.220	.110	EFZ - 832 - 323	
10 - 24	.374	.272	.252	.126	EFZ - 1024 - 374	
10 - 32	.374	.272	.252	.126	EFZ - 1032 - 374	
1/4 - 20	.500	.335	.315	.157	EFZ - 2520 - 500	
1/4 - 28	.500	.335	.315	.157	EFZ - 2528 - 500	
5/16 - 18	.500	.398	.378	.189	EFZ - 3118 - 500	
5/16 - 24	.500	.398	.378	.189	EFZ - 3124 - 500	

(All dimensions in inches)

Metric	Thread	L Insert Length	D Insert Dia.	H Hole Size (+.010 -.000)	W Min. Wall Thickness	Part Number
	M2	3.99	3.71	3.20	1.60	EFZ - M2 - 3.99
M2.5	5.79	4.50	4.00	2.00	EFZ - M2.5 - 5.79	
M3	5.79	4.50	4.00	2.00	EFZ - M3 - 5.79	
M3.5	7.19	5.31	4.80	2.40	EFZ - M3.5 - 7.19	
M4	8.20	6.15	5.60	2.80	EFZ - M4 - 8.20	
M5	9.50	6.91	6.40	3.20	EFZ - M5 - 9.50	
M6	12.70	8.51	8.00	4.00	EFZ - M6 - 12.70	
M8	12.70	10.11	9.60	4.80	EFZ - M8 - 12.70	

(All dimensions in millimeters)